

Allow the kit and specimen to come to room temperature (65°F-86°F/18°C-30°C) prior to testing.  
**AVOID PLACING ANYTHING IN THE MOUTH 10 MINUTES PRIOR TO TESTING.**

- 1** Remove the test cube and the sponge collector from the foil pouch by tearing at the notch. Place the test cube upright on a level surface.

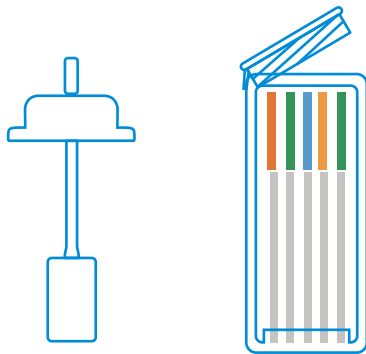

- 2** Put the sponge end of the collector on your tongue or near cheek to collect oral fluid for about 3 minutes until color on saturation indicator strip appears RED in the indicator window. If color on saturation indicator has not turned red at 7 minutes, repeat the collection using a new device, beginning with Step 1.

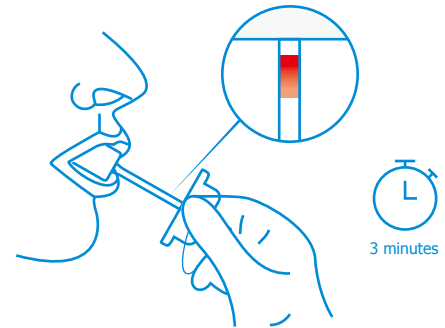

- 3** Open the test cube and place the saturated oral fluid collector inside the test cube. Press the sponge collector down firmly until it reaches the bottom of the test cube then tightly close the cube lid. Keep test cube upright on flat surface and follow Step 4.

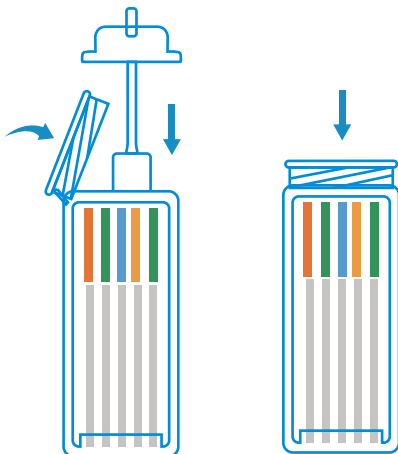

- 4** Interpreting Drug Test Results:  
Read results in 5 minutes. Do not read after 5 minutes.

### Drug Test Results

